

# ASSEMBLING THE CUTTER **PROTECIA** CUT-16

GB

\*-The details in this manual are simply for information  
\*-The manufacturer may modify this manual without being liable  
for the damage cause

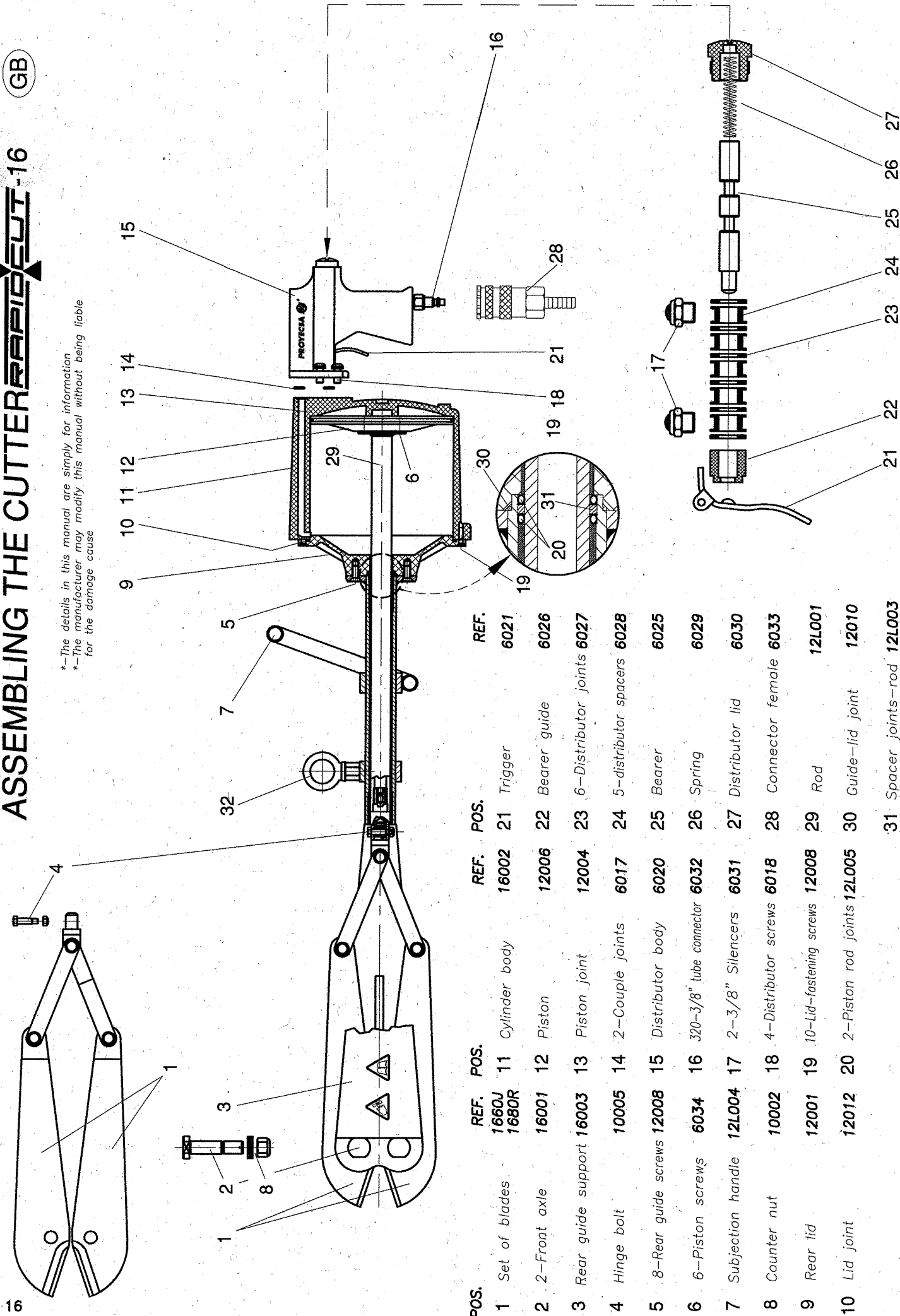

POS.	REF.	POS.	REF.
1	1660J 1680R	11	16002
2	16001	12	12006
3	16003	13	12004
4	10005	14	6017
5	12008	15	6020
6	6034	16	6032
7	12L004	17	6031
8	10002	18	6018
9	12001	19	12008
10	12012	20	12L005
		21	16002
		22	12006
		23	12004
		24	6017
		25	6020
		26	6032
		27	6031
		28	6018
		29	12008
		30	12L005
		31	12003
		32	10005
			6021
			6026
			6027
			6028
			6025
			6029
			6030
			6033
			12L001
			12010
			12L003
			6035

# TECHNICAL FEATURES

GB

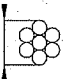
POWER SUPPLY.....Filtered, lubricated air  
CONSUMPTION.....48 Lt./cut at 7 bar  
MAXIMUM  $\phi$  CUT.....16 $\phi$  (Steel up to 70 Kg./mm<sup>2</sup>)  
5/8"  STRAND 7 x 5 $\phi$  (Steel up to 180 Kg./mm<sup>2</sup>)  
SPEED.....10 Cuts/minute  
MAXIMUM PRESSURE.....8.5 bar  
MINIMUM PRESSURE.....6 bar  
WEIGHT.....18 Kg.

## APPROPRIATE BLADE TYPE

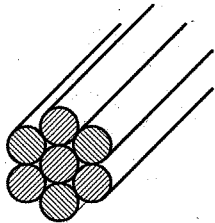

MAX. 5/8" = 7x5 $\phi$

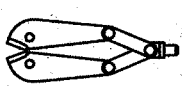

REF: 1680R  
For prestressed material  
Up to 180 Kg./mm<sup>2</sup>

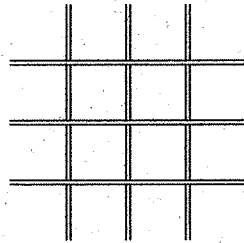

MAXIMUM 12 $\phi$

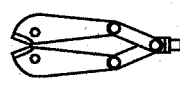

REF: 1660J  
For corrugated material  
Up to 70 Kg./mm<sup>2</sup>

## START-UP AND MAINTENANCE

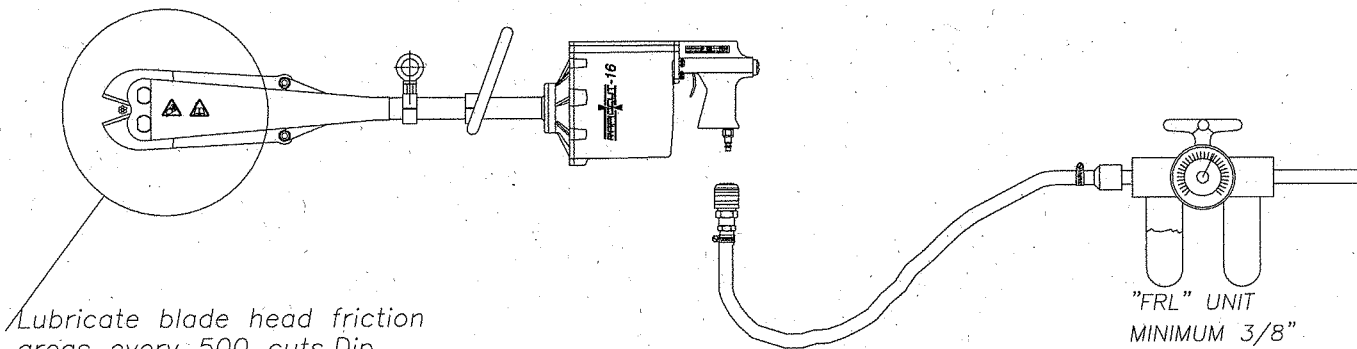

Lubricate blade head friction areas every 500 cuts. Dip it in lubricating oil and pull the trigger several times keeping the blades in the oil. THIS WAY YOU WILL OBTAIN OPTIMUM PERFORMANCE OF THE BLADES DURING THEIR USEFUL LIFE.

By installing a device to remove water, adjust pressure and lubricate air, the useful life of the body and guides of the cutter is remarkably lengthened.